

VP10

Monteringsanvisning
Monteringsvejledning
Monteringsanvisning

Asennusohjeet
Montageanweisung
Installation instructions
Instrukcja montażu

NO DK SE
FI DE GB
PL

1.

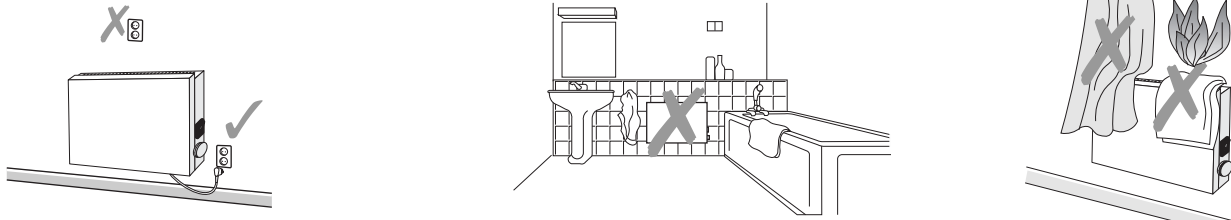

2a.

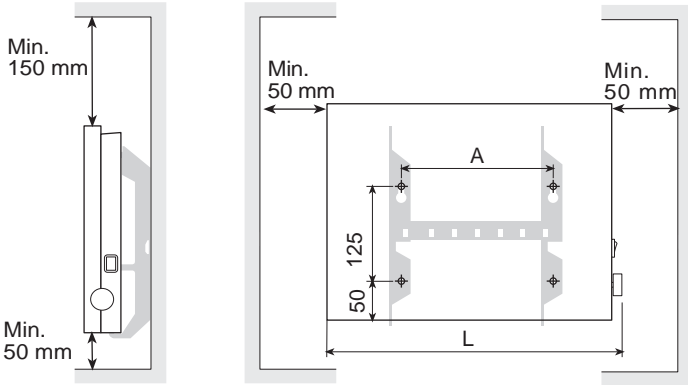

VP (H = 285 mm)

P (W)	A (mm)	L (mm)
400	200	386
600	200	498
800	200	616
1000	300	674
1200	600	846
1400	600	960
2000	600	1306

3.

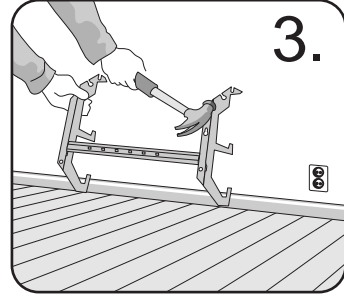

4.

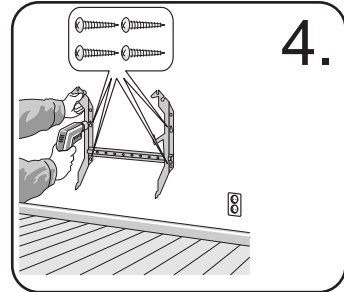

2b.

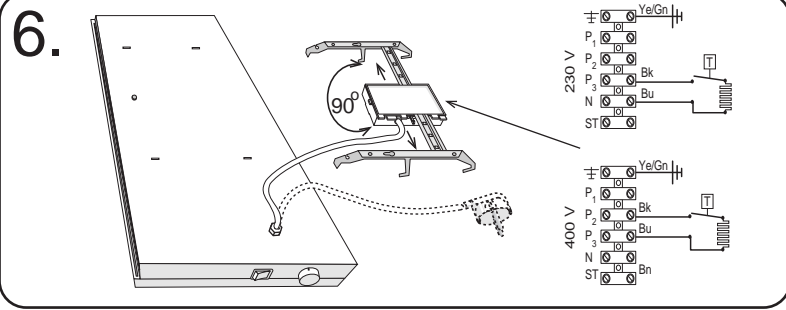
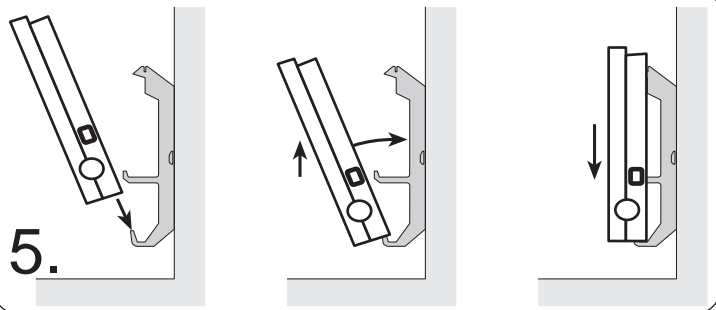

7.

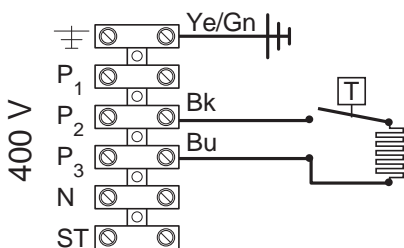
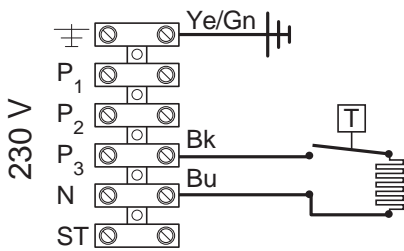

Elektrisk montasje må bare utføres av autorisert installatør.

Elektrisk montage må kun udføres af autoriseret el. installatør.

Elektrisk installation får endast utföras av behörig installatör.

Sähköasennukset saa suorittaa vain asennusoikeudet omaava asennusliike.

Anschluß darf nur durch Fachmann durchgeführt werden.

Electric installation must be carried out by an authorised electrician.

Podłączenie do sieci elektrycznej należy powierzyć elektroinstalatorowi.

Bruk
Brug
Användning
Käyttö
Bedienung
Use
Obsluga

Ye/Gn Gul/grønn Gul/Grøn Gul/Grön Kelta/Vihreä Gelb/Grün Yellow/Green Zolty/Zielony
Bk Sort Sort Svart Musta Schwarz Black Czarny
Bu Blå Blå Blå Sininen Blau Blue Niebieski



VP10

Bruksanvisning
Brugsanvisning
Bruksanvisning

Käyttöohjeet
Bedienungsanleitung
Instruction for use
Instrukcja obsługi

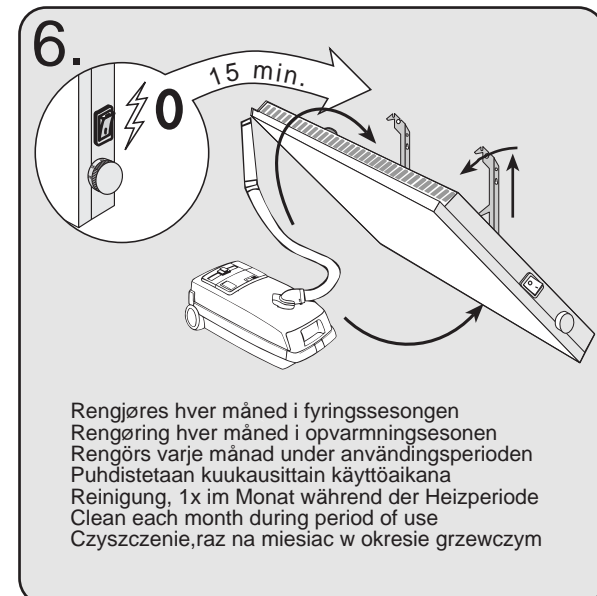
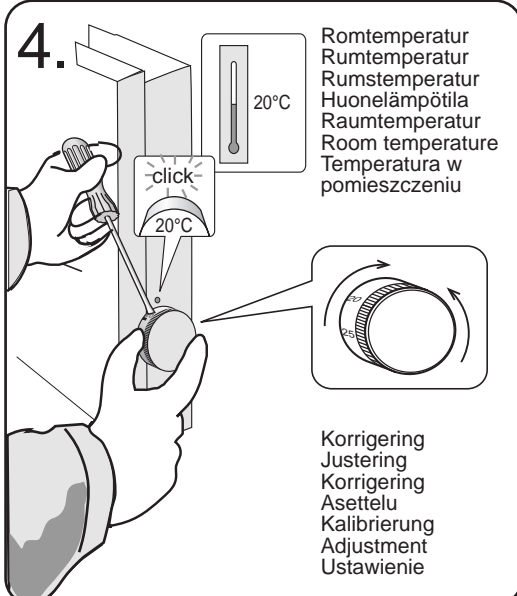
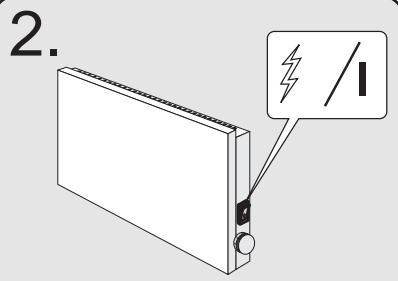
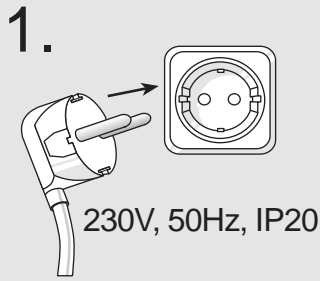

Service: ADAX AS, 3060 SVELVIK, tlf. 33 772920.
NB! Ta vare på kvitteringen for dokumentasjon av kjøpsdato.

Service: ARA-EI A/S, Håndværkervej 4, DK-4652 HAARLEV, tel. +45 56286550.
NB! Husk kvittering for købsdato.

Service: EI & Digital service AB, Ringvägen 17 S-10273 STOCKHOLM, tel. 08 845180.
OBS! Faktura/kvitto gäller som garantibevis.

Huolto: Elektroskandia Oy, Varastokatu 9, 05800 HYVINKÄÄ, puh. 010 509311.
Huom! Säilytä kuitti todistuksena ostopäivästä.

Service: ADAX AS N-3060 SVELVIK, NORWAY, Tlf. +47 33 772920.
NB! Quittung zum Nachweis des Kaufdatums aufheben.

Service: ADAX AS N-3060 SVELVIK, NORWAY, phone +47 33 772920.
NB! Retain the receipt as proof of date of purchase.

Serwis: Elektra, ul. Marynarska 14, 02-0674 Warszawa, tel. (+22) 8433282
Prosimy zachowac rachunek zakupu oraz karte gwarancyjna.

Montering
Montering
Montering
Asennus
Montage
Installation
Instalacja

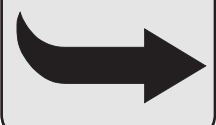

Declaration of conformity
We declare under our sole responsibility that this product is in conformity with the following standards:
EN 60 335-1 (1988)+A2+A5+A6+A51+A52+A53+A54, EN 60 335-2-30 (1992), EN 55014 (1993), EN 60555-2/-3 (1991),
EN 50082-1 (1992) following the provisions of Directives 73/23/EEC, 93/68/EEC, 89/336/EEC.
Adax AS, SVELVIK, NORWAY June 2000.

Tor Åge Kverne